

DUCATI 200-M

Automatic power factor correction equipment

Technical details

- Single-phase capacitors MONO Long Life 4I_N in PPMh, for a continuous duty under highly demanding condition in harmonic rich environments. Rated voltage 415 V, 450 V, 525 V
- Power Factor Controller series rEvolution R5. NFC connection for the exchange of the configuration with "DUCATI Smart Energy" App. Auto-sensing of the direction and the position of the TC, to ease the operations of the setup. Suitable for cogeneration plants as PV
- External steel structure painted with epoxy powder color RAL 7035
- Omni pole disconnecting switch, with door lock, and rated current 1.45I_n according to the CEI EN standard
- Contactors designed for controlling capacitive loads, equipped with an inrush current limiting device with 230 V 50 - 60 Hz power supply

General Characteristics

Rated voltage	400 V
Rated frequency	50 Hz
Insulating voltage	690 V
Ventilation	Natural
Usage	Indoor
Protection degree	IP30 - IP54
Duty	Continuous
Temperature range	-5 +40 °C
Power supply	3PH + PE + N (Up to 80 kVAr) 3PH + PE (Q _n > 80 kVAr)
Cable entry	Top
Internal connection	N07VK
Discharge devices	On each capacitor
Fuse	NH-00 GL
Standards	IEC 61439 where applicable IEC 61921
I _{SH}	50 kA (conditioned by the upstream protective device)



DUCATI 200-M Un - Cond = 415 V IP30

THD_{IMAX-C} % ≤ 50% THD I₁ % ≤ 12% Un 400 V - 50 Hz

Part n. 415.04	Qn (kVAr)	Q (400 V) (kVAr)	Bank Power (kVAr)	Steps	In (A)	In sw. (A)	LxPxH (mm)	Weight (kg)
0060	60	55	2 x 10 + 2 x 20	6	80	125	400x270x600	30
0065	70	65	10 + 3 x 20	7	94	125	400x270x600	35
0070	80	74	2 x 10 + 20 + 40	8	107	125	400x270x600	35
0075	90	83	10 + 2 x 20 + 40	9	121	250	400x270x1000	40
0080	100	92	2 x 10 + 2 x 20 + 40	10	134	250	400x270x1000	45
0085	120	111	2 x 10 + 20 + 2 x 40	12	161	250	400x270x1200	50
0090	140	130	20 + 3 x 40	7	188	400	400x270x1200	55
0095	160	148	2 x 20 + 3 x 40	8	215	400	400x270x1200	60
0100	180	167	20 + 4 x 40	9	241	400	400x270x1400	65
0105	200	185	2 x 20 + 2 x 40 + 80	10	268	400	400x270x1400	70

TECHNICAL DRAWING DUCATI 200-M IP30
60 ÷ 80 kVAr

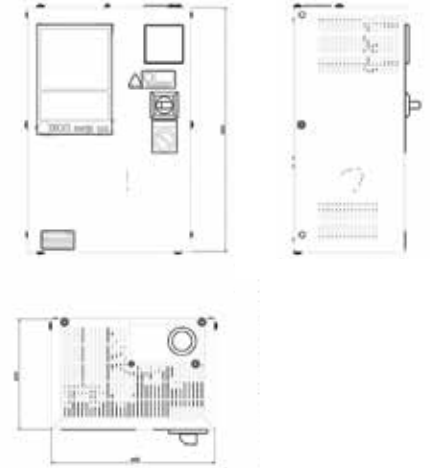

DUCATI 200-M Un - Cond = 450 V IP30

THD_{IMAX-C} % ≤ 70% THD I₁ % ≤ 20% Un 400 V - 50 Hz

Part n. 415.04	Qn (kVAr)	Q (400 V) (kVAr)	Bank Power (kVAr)	Steps	In (A)	In sw. (A)	LxPxH (mm)	Weight (kg)
0235	60	47	2 x 10 + 2 x 20	6	68	125	400x270x600	30
0240	70	55	10 + 3 x 20	7	80	125	400x270x600	35
0245	80	63	2 x 10 + 20 + 40	8	91	125	400x270x600	35
0250	90	71	10 + 2 x 20 + 40	9	103	250	400x270x1000	40
0255	100	79	2 x 10 + 2 x 20 + 40	10	114	250	400x270x1000	45
0260	120	94	2 x 10 + 20 + 2 x 40	12	137	250	400x270x1200	50
0265	140	110	20 + 3 x 40	7	160	400	400x270x1200	55
0270	160	126	2 x 20 + 3 x 40	8	182	400	400x270x1200	60
0275	180	142	20 + 4 x 40	9	205	400	400x270x1400	65
0280	200	158	2 x 20 + 2 x 40 + 80	10	228	400	400x270x1400	70

TECHNICAL DRAWING DUCATI 200-M IP30
90 ÷ 200 kVAr

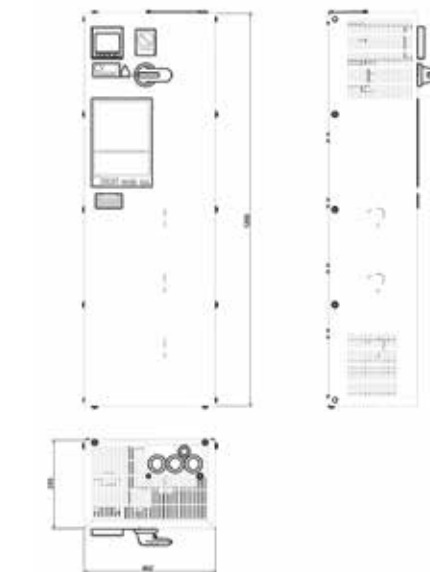

DUCATI 200-M Un - Cond = 525 V IP30

THD_{IMAX-C} % ≤ 85% THD I₁ % ≤ 27% Un 400 V - 50 Hz

Part n. 415.04	Qn (kVAr)	Q (400 V) (kVAr)	Bank Power (kVAr)	Steps	In (A)	In sw. (A)	LxPxH (mm)	Weight (kg)
0335	60	34	2 x 10 + 2 x 20	6	50	125	400x270x600	30
0340	70	40	10 + 3 x 20	7	59	125	400x270x600	35
0345	80	46	2 x 10 + 20 + 40	8	67	125	400x270x600	35
0350	90	52	10 + 2 x 20 + 40	9	75	250	400x270x1000	40
0355	100	58	2 x 10 + 2 x 20 + 40	10	84	250	400x270x1000	45
0360	120	69	2 x 10 + 20 + 2 x 40	12	101	250	400x270x1200	50
0365	140	81	20 + 3 x 40	7	117	400	400x270x1200	55
0370	160	92	2 x 20 + 3 x 40	8	134	400	400x270x1200	60
0375	180	104	20 + 4 x 40	9	151	400	400x270x1400	65
0380	200	116	2 x 20 + 2 x 40 + 80	10	168	400	400x270x1400	70

DUCATI 200-M Un - Cond = 415 V IP54

THD_{IMAX-C} % ≤ 50% THD | % ≤ 12% Un 400 V - 50 Hz

Part n. 415.04	Qn (kVAr)	Q (400 V) (kVAr)	Bank Power (kVAr)	Steps	In (A)	In sw. (A)	LxPxH (mm)	Weight (kg)
0011	5	4.7	0.7 + 1.4 + 2.9	7	7	40	500x250x700	39
0016	7.5	7.0	1.1 + 2.1 + 4.3	7	10	40	500x250x700	39
0021	10	9.3	1.4 + 2.9 + 5.7	7	13	40	500x250x700	39
0026	12.5	11.6	2.5 + 2 x 5	5	17	40	500x250x700	40
0031	17.5	16.3	2.5 + 5 + 10	7	23	40	500x250x700	40
0036	20	18	2 x 5	4	27	63	500x250x700	41
0041	25	23	5 + 2 x 10	5	34	63	500x250x700	41
0046	35	32	5 + 10 + 20	7	47	80	500x250x700	42
0051	40	37	2 x 10 + 20	4	54	80	500x250x700	42
0056	50	46	10 + 2 x 20	5	67	80	500x250x700	43
0061	60	55	2 x 10 + 2 x 20	6	80	125	500x250x700	54
0067	70	65	10 + 3 x 20	7	94	125	500x250x700	59
0071	80	74	2 x 10 + 20 + 40	8	107	125	500x250x700	59
0076	90	83	10 + 2 x 20 + 40	9	121	250	600x300x1000	77
0081	100	92	2 x 10 + 2 x 20 + 40	10	134	250	600x300x1000	82
0086	120	111	2 x 10 + 20 + 2 x 40	12	161	250	600x300x1000	93
0091	140	130	20 + 3 x 40	7	188	400	600x300x1000	98
0096	160	148	2 x 20 + 3 x 40	8	215	400	600x300x1200	109
0101	180	167	20 + 4 x 40	9	241	400	600x300x1400	114
0106	200	185	2 x 20 + 2 x 40 + 80	10	268	400	600x300x1400	119

TECHNICAL DRAWING DUCATI 200-M IP54
5-80kVAr

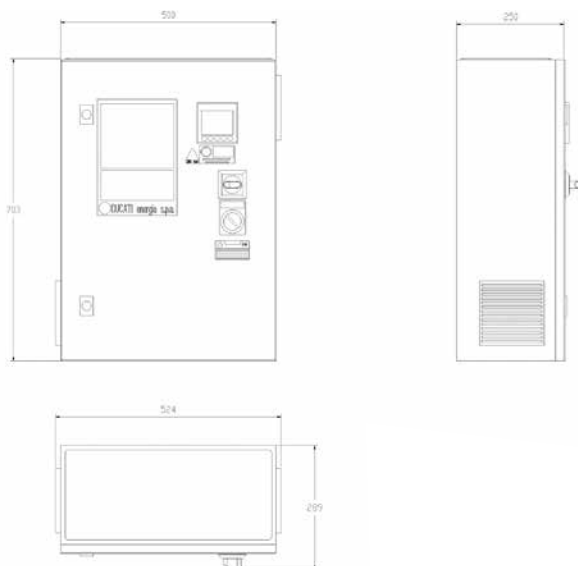

TECHNICAL DRAWING DUCATI 200-M IP54
90-200kVAr

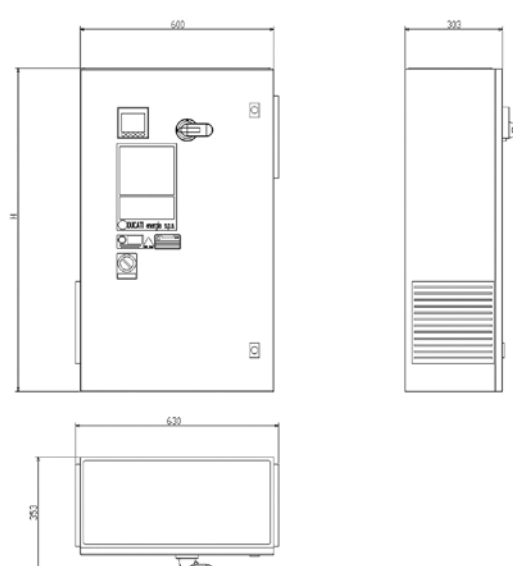

DUCATI 200-M Un - Cond = 450 V IP54

THD_{IMAX-C} % ≤ 70% THD I₁ % ≤ 20% Un 400 V - 50 Hz

Part n. 415.04	Qn (kVAr)	Q (400 V) (kVAr)	Bank Power (kVAr)	Steps	In (A)	In sw. (A)	LxPxH (mm)	Weight (kg)
0211	20	15	2 x 5 + 10	4	23	63	500x250x700	41
0216	25	19	5 + 2 x 10	5	29	63	500x250x700	41
0221	35	27	5 + 10 + 20	7	40	80	500x250x700	42
0226	40	31	2 x 10 + 20	4	46	80	500x250x700	42
0231	50	39	10 + 2 x 20	5	57	80	500x250x700	43
0236	60	47	2 x 10 + 2 x 20	6	68	125	500x250x700	54
0241	70	55	10 + 3 x 20	7	80	125	500x250x700	59
0246	80	63	2 x 10 + 20 + 40	8	91	125	500x250x700	59
0251	90	71	10 + 2 x 20 + 40	9	103	250	600x300x1000	77
0256	100	79	2 x 10 + 2 x 20 + 40	10	114	250	600x300x1000	82
0261	120	94	2 x 10 + 20 + 2 x 40	12	137	250	600x300x1200	93
0266	140	110	20 + 3 x 40	7	160	400	600x300x1200	98
0271	160	126	2 x 20 + 3 x 40	8	182	400	600x300x1200	109
0276	180	142	20 + 4 x 40	9	205	400	600x300x1400	114
0281	200	158	2 x 20 + 2 x 40 + 80	10	228	400	600x300x1400	119

DUCATI 200-M Un - Cond = 525 V IP54

THD_{IMAX-C} % ≤ 85% THD I₁ % ≤ 27% Un 400 V - 50 Hz

Part n. 415.04	Qn (kVAr)	Q (400 V) (kVAr)	Bank Power (kVAr)	Steps	In (A)	In sw. (A)	LxPxH (mm)	Weight (kg)
0311	20	11	2 x 5 + 10	4	17	63	500x250x700	41
0316	25	14	5 + 2 x 10	5	21	63	500x250x700	41
0321	35	20	5 + 10 + 20	7	29	80	500x250x700	42
0326	40	23	2 x 10 + 20	4	34	80	500x250x700	42
0331	50	29	10 + 2 x 20	5	42	80	500x250x700	43
0336	60	34	2 x 10 + 2 x 20	6	50	125	500x250x700	54
0341	70	40	10 + 3 x 20	7	59	125	500x250x700	59
0346	80	46	2 x 10 + 20 + 40	8	67	125	500x250x700	59
0351	90	52	10 + 2 x 20 + 40	9	75	250	500x250x1000	77
0356	100	58	2 x 10 + 2 x 20 + 40	10	84	250	500x250x1000	82
0361	120	69	2 x 10 + 20 + 2 x 40	12	101	250	500x250x1200	93
0366	140	81	20 + 3 x 40	7	117	400	500x250x1200	98
0371	160	92	2 x 20 + 3 x 40	8	134	400	500x250x1200	109
0376	180	104	20 + 4 x 40	9	151	400	500x250x1400	114
0381	200	116	2 x 20 + 2 x 40 + 80	10	168	400	500x250x1400	119