

MODULO XD Three phase capacitors

MODULO XD capacitors are used for the fixed and automatic PFC systems in a wide range of industrial applications.

The three elements are housed in a plastic container which, together with the impregnating agents, assures dual insulation between the wound cores and metal enclosure.

To guarantee perfect filling during the resin impregnation process, the process itself is carried out prior to the elements being placed in the enclosure; in this way the distribution and uniformity of the impregnation can be subjected to a complete visual and dimensional inspection.

The overpressure protection system is specifically dimensioned so as to constantly ensure maximum safety in terms of ground protection and protection against the risk of arcing, even in conditions where there is a high energy density.

The characteristics of these capacitors are especially suitable for continuous duty under highly demanding conditions in harmonic rich environments.

General Characteristics

Power Range	1.5 ÷ 50 kVAr
Voltage range	230 ÷ 800 V
Rated frequency	50 Hz/60 Hz
Capacitance tolerance	-5 +10%
Duty	Continuous
Dielectric losses	≤ 0.2 W/kVAr
Life expectancy ^a	≥110000h -25/D ≥130000h -25/C
Max dV/dt	100 V /μs
Temperature class	-25/D
Max overload I _n	4 x I _n
Max inrush current	200 I _n
Terminals	Screw clamps
Protection rating	IP20 (IP54 on request)
Internal connection	Delta
Discharge resistance	External (50 V after 60")
Impregnating material	Eco-friendly resin
Altitude	≤ 4000 m s.l.m.
Storage Temperature	-40 +80 °C
Test voltage (AC) between terminals	2.15 U _n x 2"
Test voltage between terminals and case	3kV x 10" (U _n ≤660 V)
Standards	IEC 831 - 1/2
Approvals	 Excluding Ø 125 mm

U _n (V)	Q _n (kVAr)	I _n (A)	C (μF)	DxH (mm)	Type	Pcs x box	Part n. 41646.	Dim. Box
240 (60Hz)	1.5	3.6	3x23	65x165	A	14	0020	E
	2.5	6	3x28	65x165	A	14	0030	E
	5	12	3x77	75x255	A	6	0050	F
	7.5	18	3x115	85x255	A	6	0080	F
	10	24	3x154	100x255	A	6	0100	G
	12.5	30	3x192	100x255	A	6	0150	H
400	15	36	3x230	116x255	A	6	0200	H
	1.5	2.2	3x9.9	65x165	A	14	1020	E
	2.5	3.6	3x17	65x165	A	14	1030	E
	5	7.2	3x33	75x165	A	6	1050	C
	7.5	10.8	3x50	75x255	A	6	1080	F
	10	14.4	3x66	75x255	A	6	1100	F
	12.5	18.0	3x83	85x255	A	6	1150	F
	15	21.7	3x99	90x255	A	6	1200	F
	20	28.9	3x133	100x255	A	6	1260	G
	25	36.1	3x166	116x255	A	4	1310	H
	30	43.3	3x199	116x290	A	4	1360	H
415	40	57.7	3x265	116x370	A	4	1370	I
	45	65	3x298	125x370	B	4	1375	I
	50	72.2	3x332	125x370	B	4	1380	I
	1.5	2.1	3x9.2	65x165	A	14	2020	E
	2.5	3.5	3x15	65x165	A	14	2030	E
	5	7.0	3x31	75x165	A	6	2050	C
	7.5	10.4	3x46	75x255	A	6	2080	F
	10	13.9	3x62	75x255	A	6	2100	F
	12	17.4	3x77	85x255	A	6	2150	F
	15	20.9	3x92	90x255	A	6	2200	F
	20	27.8	3x123	100x255	A	6	2260	G
	25	34.8	3x154	116x255	A	4	2310	H
	30	41.7	3x185	116x290	A	4	2360	H
40	55.6	3x246	116x370	A	4	2370	I	
45	62.6	3x277	116x370	A	4	2375	I	
50	69.6	3x308	125x370	B	4	2380	I	

Standard box dimensions: C= 190x285x325 mm G= 225x340x270 mm
E= 195x390x255 mm H= 330x340x225 mm F= 185x290x270 mm
I= 270x270x450 mm
Weight: 10÷12 kg



MODULO XD

Three phase capacitors

TECHNICAL DRAWING TYPE A

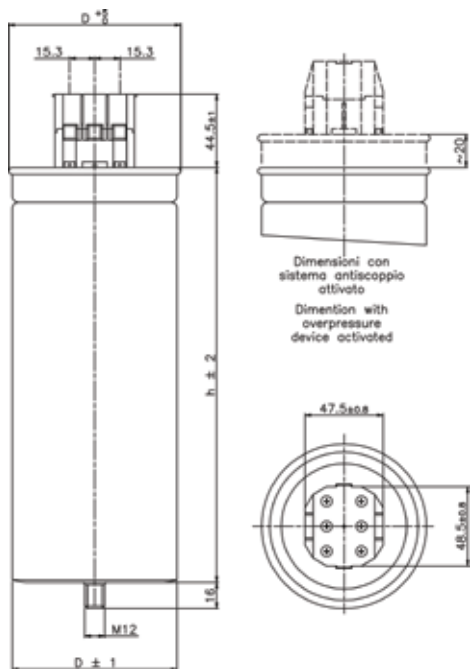

Terminals and stud	Fixing torque
Screw terminals	1.5 Nm
M10**	6 Nm
M12	10 Nm

(**) Complete the tightening using two wrenches.

Un (V)	Qn (kVAr)	In (A)	Cn (µF)	DxH (mm)	Type	Pcs x box	Part n. 41646.	Dim. Box
440	1.5	2	3x8.2	65x165	A	14	3023	E
	2.5	3.3	3x14	65x165	A	14	3033	E
	5	6.6	3x27	75x165	A	6	3053	C
	7.5	9.8	3x41	75x255	A	6	3083	F
	10	13.1	3x55	75x255	A	6	3103	F
	12.5	16.4	3x69	85x255	A	6	3153	F
	15	19.7	3x82	90x255	A	6	3203	F
	20	26.2	3x110	100x255	A	6	3263	G
	25	32.8	3x137	116x255	A	4	3313	H
	30	39.4	3x164	116x290	A	4	3363	H
	40	52.5	3x219	116x370	A	4	3373	I
	45	59.0	3x247	116x370	A	4	3378	I
50	65.6	3x274	125x370	A	4	3383	I	
450	1.5	1.9	3x7.9	65x165	A	14	3020	E
	2.5	3.2	3x13	65x165	A	14	3030	E
	5	6.4	3x26	75x165	A	6	3050	C
	7.5	9.6	3x39	75x255	A	6	3080	F
	10	12.8	3x52	75x255	A	6	3100	F
	12.5	16.0	3x65	85x255	A	6	3150	F
	15	19.2	3x79	90x255	A	6	3200	F
	20	25.7	3x105	100x255	A	6	3260	G
	25	32.1	3x131	116x255	A	4	3310	H
	30	38.5	3x157	116x290	A	4	3360	H
	40	51.3	3x210	116x370	A	4	3370	I
	45	57.7	3x236	116x370	A	4	3375	I
50	64.2	3x262	125x370	A	4	3380	I	
500	1.5	1.7	3x6.4	65x165	A	14	4020	E
	2.5	2.9	3x11	65x165	A	14	4030	E
	5	5.8	3x21	75x165	A	6	4050	C
	7.5	8.7	3x32	75x255	A	6	4080	F
	10	11.5	3x42	75x255	A	6	4100	F
	12.5	14.4	3x53	85x255	A	6	4150	F
	15	17.3	3x64	90x255	A	6	4200	F
	20	23.1	3x85	100x255	A	6	4260	G
	25	28.9	3x106	116x255	A	4	4310	H
	30	34.6	3x127	116x290	A	4	4360	H
	40	46.2	3x170	116x370	A	4	4370	I
	45	52.0	3x191	116x370	A	4	4375	I
50	57.7	3x212	125x370	A	4	4380	I	

Standard box dimensions:
 C= 190x285x325 mm G= 225x340x270 mm E= 195x390x255 mm H= 330x340x225 mm
 F= 185x290x270 mm I= 270x270x450 mm

Weight: 10÷12 kg

Un (V)	Qn (kVAr)	In (A)	Cn (μF)	DxH (mm)	Type	Pcs x box	Part n. 41646.	Dim. Box
525	10	11	3x38	85x255	A	6	5130	F
	12.5	13.7	3x48	85x255	A	6	5170	F
	15	16.5	3x58	100x255	A	6	5230	G
	20	22	3x77	116x255	A	4	5270	H
	25	27.5	3x96	116x255	A	4	5330	H
	30	33	3x115	116x290	A	4	5370	H
	40	44	3x154	116x370	A	4	5373	I
	45	49.5	3x173	116x370	A	4	5377	I
50	55	3x192	125x370	A	4	5385	I	
550	1.5	1.6	3x5.3	65x165	A	14	5020	E
	2.5	2.6	3x8.8	65x165	A	14	5030	E
	5	5.2	3x18	75x165	A	6	5050	C
	7.5	7.9	3x26	75x255	A	6	5080	F
	10	10.5	3x35	75x255	A	6	5100	F
	12.5	13.1	3x44	85x255	A	6	5150	F
	15	15.7	3x53	90x255	A	6	5200	F
	20	21	3x70	100x255	A	6	5260	G
	25	26.2	3x88	116x255	A	4	5310	H
	30	31.5	3x105	116x290	A	4	5360	H
	40	42	3x140	116x370	A	4	5372	I
	45	47.2	3x158	116x370	A	4	5375	I
50	52.5	3x175	125x370	A	4	5380	I	
690 (*)	10	8.4	3x22	75x255	A	6	6100	F
	12.5	10.5	3x28	85x255	A	6	6150	F
	15	12.6	3x33	90x255	A	6	6200	F
	20	16.7	3x45	100x255	A	6	6260	G
	25	20.9	3x56	116x255	A	4	6310	H
	30	25.1	3x67	116x290	A	4	6360	H
	40	33.5	3x89	116x370	A	4	6370	I
	45	37.7	3x100	116x370	A	4	6375	I
50	41.8	3x111	125x370	A	4	6380	I	
800 (*)	10	7.2	3x17	75x255	A	6	8100	F
	12.5	9.0	3x21	85x255	A	6	8150	F
	15	10.8	3x25	90x255	A	6	8200	F
	20	14.4	3x33	100x255	A	6	8260	G
	25	18.0	3x41	116x255	A	4	8310	H
	30	21.7	3x50	116x290	A	4	8360	H
	40	28.9	3x66	116x370	A	4	8370	I
	45	32.5	3x75	116x370	A	4	8375	I
50	36.1	3x83	125x370	A	4	8380	I	

(*) Without discharge resistance.

Standard box dimensions:

C= 190x285x325 mm G= 225x340x270 mm E= 195x390x255 mm H= 330x340x225 mm

F= 185x290x270 mm I= 270x270x450 mm

Weight: 10 ÷ 12 kg

To enable the overpressure protection device to operate efficiently, it is necessary to leave a gap of at least 30 mm. above the element and use flexible leads for the connection.

TECHNICAL DRAWING TYPE B

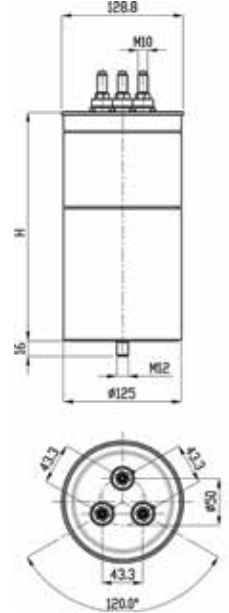

Terminals and stud	Fixing torque
Screw terminals	1.5 Nm
M10**	6 Nm**
M12 stud	10 Nm

(**) Complete the tightening using two wrenches.

Terminal cover IP54

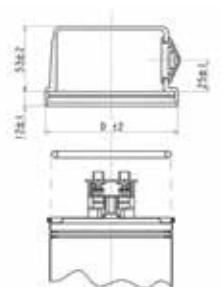

Code	Diam. (mm)	Packages n. pz. per box
316.52		
.3338	85	30
.3339	90	30
.3340	100	30
.3341	116	30